



# EU-TYPE EXAMINATION CERTIFICATE

According to Annex IV, Part A of 2014/33/EU Directive

<b>Certificate No.:</b>	EU-UCM 006-2
<b>Notified Body:</b>	TÜV SÜD Industrie Service GmbH Westendstr. 199 80686 Munich – Germany Identification No. 0036
<b>Certificate Holder:</b>	Blain Hydraulics GmbH Pfaffenstr. 1 74078 Heilbronn - Germany
<b>Manufacturer of the Test Sample:</b> (Manufacturer of Serial Production – see Enclosure)	Blain Hydraulics GmbH Pfaffenstr. 1 74078 Heilbronn - Germany
<b>Product:</b>	Hydraulic valve for a brake element as part of a protection against unintended downward car movement
<b>Type:</b>	L10 1½"
<b>Directive:</b>	2014/33/EU
<b>Reference Standards:</b>	EN 81-20:2020 EN 81-50:2020
<b>Test Report:</b>	EU-UCM 005/2-007/2 of 2022-10-06
<b>Outcome:</b>	The product conforms to the essential health and safety requirements of the mentioned Directive if the requirements of the annex to this EU-type examination certificate are kept.
<b>Date of Issue:</b>	2022-11-01

  
 Bernd Gründling  
 Notified Body LCC

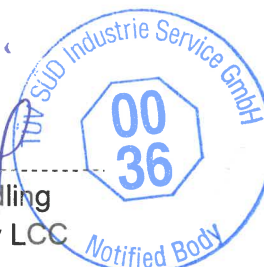

**Annex to the EU-type examination Certificate  
No. EU-UCM 006-2 of 2022-11-01**



Industrie Service

**1 Scope of application**

Hydraulic valve for a brake element as part of a protection against unintended downward car movement, type L10 1½"

Maximum braking distance after triggering up to	800 mm
Maximum permissible distance: level position - triggering up to	250 mm
Permissible nominal speed up to	1.0 m/s
Permissible release speed up to	1.3 m/s
Permissible nominal flow	≤ 400 l/min
Nominal pressure range	10 - 59 bar
Viscosity range	20 - 450 cSt

**2 Terms and Conditions**

- 2.1 For identification and information about the principal design and operation and for demarcation of the examined and approved sample the approval drawing, no. L10-1.5" F KS a (Blatt 1-2) of 2022-07-20 with certification stamp of 2022-10-06 has to be enclosed to the EU-type examination certificate and its annex.
- 2.2 The above-mentioned safety component represents only one part of the protective equipment against movements of the car in downward direction. Only in combination with a detection and triggering component (also two different components are possible), which must be subjected to an own EU-type examination according to the test procedure specified in EN 81-50:2020 (D), section 5.8, the created system can fulfil the requirements for a protection means in accordance with EN 81-20:2020 (D), section 5.6.7.
- 2.3 The installer must prepare test instructions in order to meet the overall concept of the elevator system, enclose these test instructions in the elevator documents and if necessary provide important tools or measuring devices which allow easy tests (e.g., when landing doors are closed).
- 2.4 Provided that the voltage drop on the coil has occurred within the distance of 250 mm as indicated in the scope of application it can be assumed that the requirements for braking distance and acceleration according to EN 81-20:2020, point 5.6.7.5 and 5.6.7.6 are met.
- 2.5 The Blain UCM-valve is an electrically operated check valve which can only be used in connection with an elevator valve as an additional safety valve for the prevention of unintended downward travel while a landing door is open according to EN 81-20:2020, section 5.6.7. The detection of emergency cases, the function of the brake in an upwards direction and the triggering of both brakes is the task of the control unit.
- 2.6 In order for it to function properly, the magnet of the Blain UCM valve must be de-energized in accordance with the requirements of EN 81-20:2020, Section 5.6.6.5 at the latest when the car has moved a maximum of 250 mm from the flush position with the door open. Dead times of the electronic system must be considered.
- 2.7 The installer must be provided with written confirmation of the compliance of the component with the type tested part as well as of the guaranteed braking distances and accelerations.
- 2.8 The EU-type examination certificate may only be used in combination with the corresponding annex and enclosure (List of authorized manufacturer of the serial production). The enclosure will be updated immediately after any change by the certification holder.

**Annex to the EU-type examination Certificate  
No. EU-UCM 006-2 of 2022-11-01**



Industrie Service

**3 Remarks**

3.1 This EU-type examination certificate was issued according to the following standards:

- EN 81-20:2020 (D), part 5.6.7
- EN 81-50:2020 (D), part 5.8

A revision of this EU-type examination certificate is inevitable in case of changes or additions of the above mentioned standards or of changes of state of the art.

3.2 In case that there is a risk of unintended car movement in the upward direction, appropriate measures must be taken by the installer.

3.3 The Certification Body LCC of the TÜV SÜD Industrie Service GmbH is a Certification Body accredited by DAkkS according to DIN EN ISO 17065. The accreditation is only valid for the scope of accreditation listed in the Annex of the certificate D-ZE-14153-03-02.

**Enclosure to the EU-type examination Certificate  
No. EU-UCM 006-2 of 2022-11-01**



Industrie Service

**Authorised Manufacturer of Serial Production – Production Sites (valid from: 2022-07-26):**

<b>Company</b>	<b>Blain Hydraulics GmbH</b>
<b>Address</b>	Pfaffenstr. 1 74078 Heilbronn - Germany

- END OF DOCUMENT -

Based on: Application from Blain Hydraulics GmbH of 2022-07-26

**Note:** The English text is a translation of the German original. In case of any discrepancy, the German version is valid only.

Nr.	Benennung	Zaichnungsnummer	Material	Arbeitsnummer	Stk.
1	Gehäuse L10 15" F mit K5	L 112 F K5	ACU/AluPb	500250	1
2	Wahlhebel M14x1,5	Wahlhebel M14x1,5		102076	1
3	Kolbenstange	Dreiecksstange Kolbenstange		101986	1
4	KV1 0,2 Standard (Aufg.9)	Standard KV1 (0 - Y40)		102097	1
5	Magnetrolle AB	Magnetrolle AB		102042	1
6	Übersetzungsverhältnis 10 lang	Schraube 10 lang		102100	1
7	Versteckschraube DIN913 M10x1,8 blauverzinkt	DIN913 M10x1,8 blauverzinkt		100365	3
8	Feder	F 65		100752	1
9	Magnetrolle "ab"	EN 10270-1 SH		100752	1
10	Magnetrolle	1,4306 (A286) (18.8)		102021	1
11	Magnetrolle	EV 135		102482	1
12	Magnetrolle	1,0718 (118MnPS30)		102470	1
13	Stanzscheibe 2,2	3,1848 (EN AW-2027)		102478	1
14	Stanzscheibe 2,2	X12CrNi18-9 Nr. 1.4305		102471	1
15	Stanzscheibe 2,2	Drahtseil		102225	1
16	O-Ring 26x2 NBR 70	NBR		102261	1
17	Versteckschraube G1/4"	1,0718 (118MnPS30)		102446	1
18	L 10 60x6x 1/4"	L 10 60x6x 1/4"		102716	1
19	Typenschild mit CE 0038	EV 140 CE 0038	Aluminium mit Röhren 3M 455	100166	1
20	Feder	F 81	Federfeder aus Eln 10270-1 SH	100074	4
21	Zylinderboltschraube DIN912 M10x2,8 schwarzverzinkt	DIN912 M10x2,8 schwarzverzinkt		100241	1
22	O-Ring 40x3 NBR 70	O-Ring 40x3 NBR	NBR	102412	1
23	Deckel L10 15"	L 12	ACU/AluPb	100186	1
24	Stahlschulter	DIN5401-4	Kugelmutter, Gabelkranz 3	100429	1
25	Kugelschraubenschraube	L 145	DIN 912 - M14x14	100008	1
26	Gewindestiftkopfen 1/2"	Cera Mit.Nr.: 40706	LD-PE	100004	2
27	Overschraubenschlüssel 15"	Cera Mit.Nr.: 40460	LD-PE	102292	1
28	Versteckschraube G1/4"	EV 296	1,0718 (118MnPS30)	100186	1
29	Feder	F 80	Federfeder aus 10270-1 SH	100180	1
30	Stahlschulter	DIN5401-6	Kugelmutter, Gabelkranz 3	100187	1
31	Notstiftschraube	F 89	EN 10270-1 SH	102543	1
32	L 10 Filter für 1,5"-2,5", L20	EV 148 H	Aluminium mit Röhren 3M 455	500055	1

Alternative Bauteile zu Position 31 (Filterbaugruppe):

Nr.	Benennung	Zaichnungsnummer	Material	Arbeitsnummer	Stk.
31 a	Gewebte Elnschrauber für 1,5"-2,5", L20	L 166	118MnPS30+C	500054	1
31 b	Gewebte Elnschrauber für 1,5"-2,5", L20 - fein	L 168	118MnPS30+C	500097	1
31 c	Gewebte Elnschrauber für 1,5"-2,5", L20	L 167	1,4301 Drahtgewebe	500051	1
31 d	Gewebte Elnschrauber für 1,5"-2,5", L20 - fein	L 169	1,4301 Drahtgewebe	500050	1



0 6. OKT. 2022  
**GEPRÜFT / APPROVED**  
 TUV SÜD Industrie Service GmbH  
 Prüflaboratorium für Produkte der Feinmechanik  
 Westendstraße 109  
 80696 München  
 Sachverständigen / Expert



Master Typenschild (Art.Nr. 16)

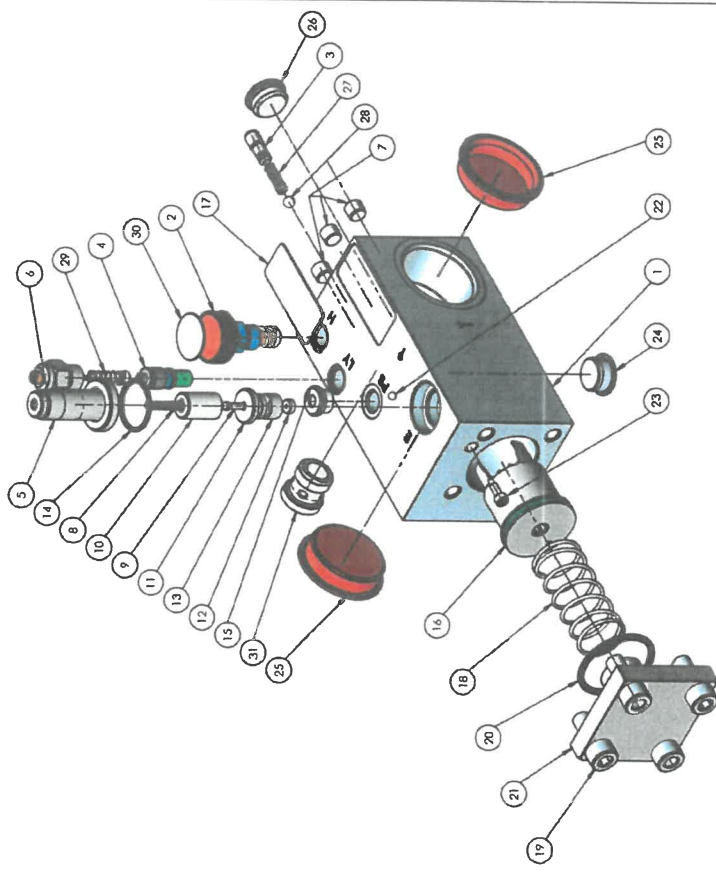
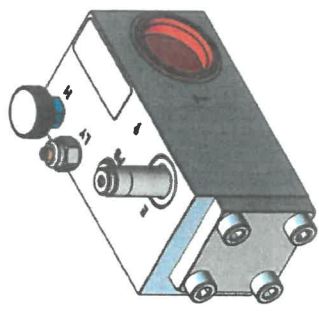

Wahlhebel		Wahlhebel		Wahlhebel	
Art.Nr.	102435	Art.Nr.	102435	Art.Nr.	102435
Zeichnungs-Nr.	L10 1,5" F KS b	Zeichnungs-Nr.	L10 1,5" F KS b	Zeichnungs-Nr.	L10 1,5" F KS b
Blatt 1/2		Blatt 1/2		Blatt 1/2	

Bein Hydraulik GmbH | Pöhlmannstr. 1 | 70070 Heilbronn, Germany | Tel.: +49-7143-38210 Fax: +49-7143-382190 www.bein.de

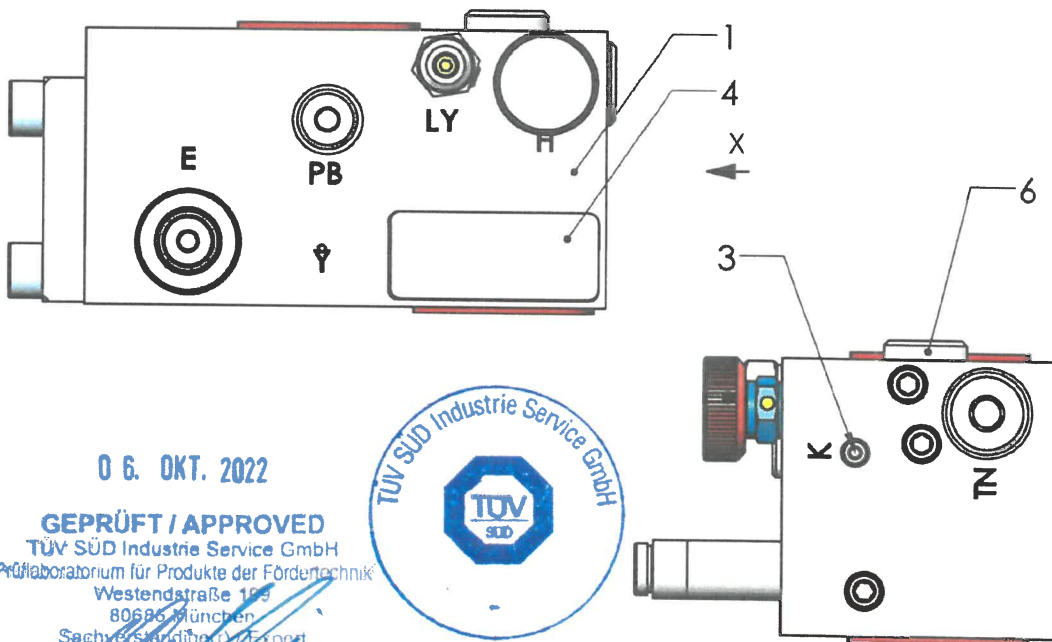
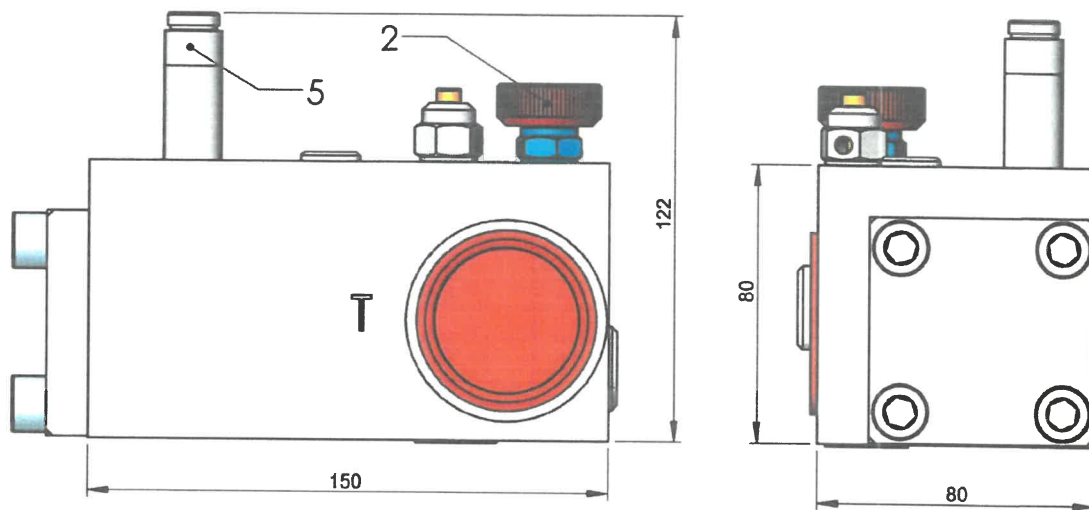

06. OKT. 2022

**GEPRÜFT / APPROVED**  
 TÜV SÜD Industrie Service GmbH  
 Prüflaboratorium für Produkte der Fördertechnik  
 Westendstraße 189  
 80696 München  
 Sachverständigen für Export



Ansicht X

Position	Benennung
1	Gehäuse L10F 1½" mit KS
2	Notablaß M14x1,5
3	Kolbensicherung
4	Typenschild mit CE (EV-L10)
5	Magnetrohr AB
6	Filter



Cert. No. EU-UCM 006/2	
Client No. XX XX XX	
Model L10 1.5"	
l/min	ber
l/min	max ber max

Muster Typenschild (Art.Nr.4)

Mittwoch, 14. September 2022 13:32:24	F.Pausder	gratis; Freimaßtoleranz: DIN ISO 2768m			Ungefähres Gewicht in Gramm :	
	Werkstoff:	Datum	Name	Maßstab	Benennung:	Art.-Nr.: 103435
	Rohmaße:	gez 20.07.2022	CQ	1:2	Drucksperrventil 1.5" mit KS	Zeichnungs-Nr.: L10 1.5" F KS b