



Industrie Service

# EU-TYPE EXAMINATION CERTIFICATE

According to Annex IV, Part A of Directive 2014/33/EU

<b>Certificate No.:</b>	EU-RV 014
<b>Notified Body:</b>	TÜV SÜD Industrie Service GmbH Westendstr. 199 80686 Munich - Germany Identification No. 0036
<b>Certificate Holder:</b>	Blain Hydraulics GmbH Pfaffenstraße 1 74078 Heilbronn - Germany
<b>Manufacturer of the Test Sample:</b> (Manufacturer of Serial Production - see Enclosure)	Blain Hydraulics GmbH Pfaffenstraße 1 74078 Heilbronn - Germany
<b>Product:</b>	Rupture valve as protection against falling of the car in hydraulic lifts
<b>Type:</b>	R10 2½"
<b>Directive:</b>	2014/33/EU
<b>Reference Standards:</b>	EN 81-20:2020 EN 81-50:2020
<b>Test report:</b>	No. EU-RV009-019 dated 2021-04-20
<b>Outcome:</b>	The product conforms to the essential health and safety requirements of the mentioned Directive if the requirements of the annex to this EU-type examination certificate are kept.
<b>Date of Issue:</b>	2021-04-20

  
Achim Janocha

Notified Body LCC



**Annex to the EU-Type Examination Certificate**  
**No. EU-RV 014 of 2021-04-20**



**1 Scope of application**

1.1 Rupture valve as protection against falling of the car in hydraulic lifts, type R10 2½"

1.2 Technical Data

<b>Permissible nominal flow rate</b>	<b>700 - 1250</b>	<b>l/min</b>
<b>Pressure range</b>	<b>10 - 80</b>	<b>bar</b>
<b>Operating viscosity</b>	<b>15 - 400</b>	<b>cSt</b>
<b>Temperature range</b>	<b>0 - 65</b>	<b>°C</b>

**2 Conditions**

2.1 For identification and information about the principal construction and mode of operation of the tested and approved test sample, the approval drawing no. R10 2½" dated 2004-08-09 with modification index 'a' dated 2021-01-28 (sheet 1) with certification stamp dated 2021-04-20 must be attached to the EU-type examination certificate and its annex.

2.2 The connection and setting of the rupture valves must be carried out in accordance with the manufacturer's R10 operating instructions with certification stamp dated 2021-04-20.

2.3 Hydraulic fluids recommended by the manufacturer must be used. Hydraulic fluids with a specification outside the scope of the rupture valve are not permitted.

2.4 In the case of rupture valves that are not directly attached to the cylinder, the connection between the cylinder and the rupture valve must be made via by calculation proven short rigid pipes (pressure hoses are not permitted).

2.5 The EU-type examination certificate may only be used in combination with the corresponding annex and enclosure (List of authorized manufacturers of the serial production). The enclosure will be updated immediately after any change by the certification holder.

**3 Remarks**

3.1 This EU-type examination certificate has been issued in accordance with or on basis of the following standards:

- EN 81-20:2014 (D), Number 5.6.3.8
- EN 81-50:2014 (D), Number 5.9
- EN 81-20:2020 (D), Number 5.6.3.8
- EN 81-50:2020 (D), Number 5.9

A revision of this EU-type examination certificate is inevitable in case of changes or additions of the above-mentioned standards or of changes of state of the art.

3.2 The test results only relate to the safety component "rupture valve" and the associated EU-type examination.

3.3 At the rupture valve, there shall be a label with the information necessary for the component's identification with the name of the manufacturer, EU-type examination sign and details of type.

**Enclosure to the EU-Type Examination Certificate  
No. EU-RV 014 of 2021-04-20**



Industrie Service

**Authorised Manufacturer of Serial Production – Production Sites (valid from: 2021-02-03):**

<b>Company</b>	Blain Hydraulics GmbH
<b>Address</b>	Pfaffenstraße 1 74078 Heilbronn - Germany

- END OF DOCUMENT -

# R10 2 1/2" Stückliste + Explosionsansicht

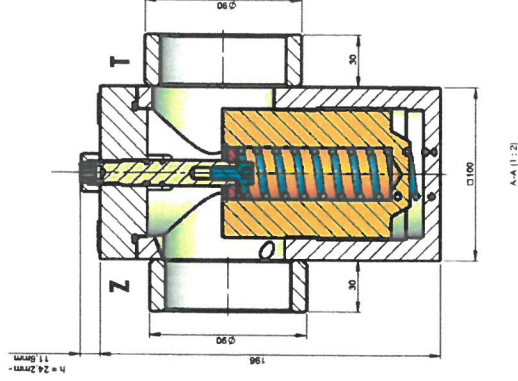
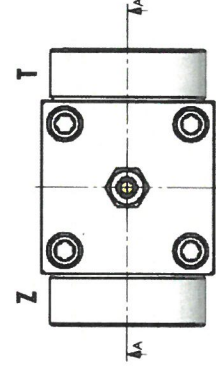
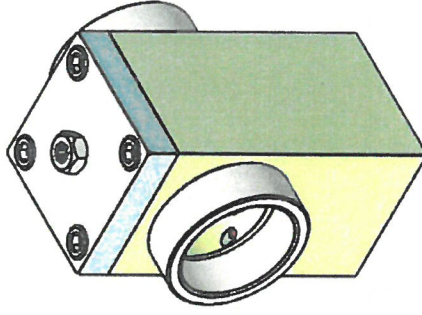
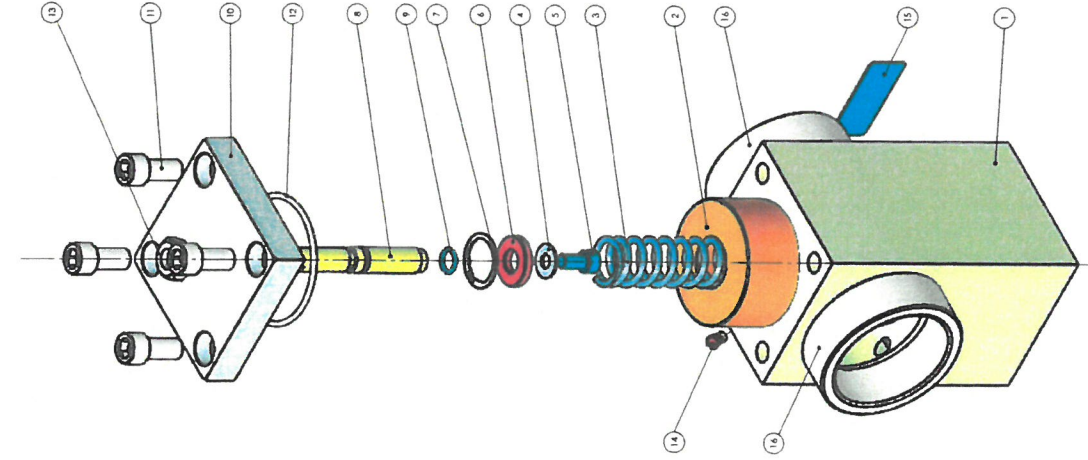

Nr.	Bezeichnung	Zeichnungsnummer	Material	Anschlussummer (EN)
1	Oberteil R10 2 1/2"	R 113	1.0570 (S355J2K3)	103844
2	Kolben 2. H.	R 133	1.0718 (11SMnPS30)	103736
3	Feder	R 90	Federstahl EN 10276-1 St	100778
4	Kolbenring	DN912 M16x18 schwarzverzinkt	schwarzverzinkt	100844
5	Zylinderbohrung DN912 M16x18 schwarzverzinkt	DN912 M16x18 schwarzverzinkt	schwarzverzinkt	100100
6	Verriegelungsbohrung für R10 2 1/2"	R 146	1.0718 (11SMnPS30)	103785
7	Verriegelungsbohrung DN 472 36x1.2	DN 472 36x1.2	1.1248 C725	500281
8	Stiftbohrung R10 2 1/2"	R 143 P	1.0718 (11SMnPS30)	103759
9	O-Ring 11x2 NBR 70	O-Ring 11x2 NBR	NBR	100200
10	Dichtung R10 2 1/2"	R 123	3.1645 (EN AW-2007)	103750
11	Zylinderbohrung DN912 M16x18 schwarzverzinkt	DN912 M16x18 schwarzverzinkt	schwarzverzinkt	100775
12	O-Ring 72x3 NBR 70	O-Ring 72x3 NBR	NBR	100262
13	Sechskantmutter DIN 934 M14 blauverzinkt	DIN934 M14 blauverzinkt	blauverzinkt	100123
14	Flach-Oase	R 148 2.0	Aluminium mit Nickel 3M 468	103775
15	Typenbohrung mit CE 0036	EV 148 CE 0036	Aluminium mit Nickel 3M 468	103775
16	Muffe zylinderförmig R10 2 1/2"	RA 153	1.0570 (S355J2K3)	103811

20. APR. 2021

GEPRÜFT / APPROVED

TUV SÜD Industrie Service GmbH

Prüflaboratorium für Produkte der Ex-Technik

Westendstraße 199

80699 München

Sachverständigenbüro

TUV SÜD Industrie Service GmbH

Druck: 20. Januar 2021 10:23:23

Version: 1.0

Material: 1.0570 (S355J2K3)

Zeichnungs-Nr.: R10 2 1/2"

Druck: 20. Januar 2021 10:23:23

Version: 1.0

Material: 1.0570 (S355J2K3)

Zeichnungs-Nr.: R10 2 1/2"