



Industrie Service

EU-TYPE EXAMINATION CERTIFICATE

According to Annex IV, Part A of Directive 2014/33/EU

Certificate No.:	EU-RV 015
Notified Body:	TÜV SÜD Industrie Service GmbH Westendstr. 199 80686 Munich - Germany Identification No. 0036
Certificate Holder:	Blain Hydraulics GmbH Pfaffenstraße 1 74078 Heilbronn - Germany
Manufacturer of the Test Sample: (Manufacturer of Serial Production - see Enclosure)	Blain Hydraulics GmbH Pfaffenstraße 1 74078 Heilbronn - Germany
Product:	Rupture valve as protection against falling of the car in hydraulic lifts
Type:	R10 3"
Directive:	2014/33/EU
Reference Standards:	EN 81-20:2020 EN 81-50:2020
Test report:	No. EU-RV009-019 dated 2021-04-20
Outcome:	The product conforms to the essential health and safety requirements of the mentioned Directive if the requirements of the annex to this EU-type examination certificate are kept.
Date of Issue:	2021-04-20

Achim Janocha

Notified Body LCC



Annex to the EU-Type Examination Certificate
No. EU-RV 015 of 2021-04-20



1 Scope of application

1.1 Rupture valve as protection against falling of the car in hydraulic lifts, type R10 3"

1.2 Technical Data

Permissible nominal flow rate	1200 - 2100	l/min
Pressure range	10 - 60	bar
Operating viscosity	15 - 400	cSt
Temperature range	0 - 65	°C

2 Conditions

2.1 For identification and information about the principal construction and mode of operation of the tested and approved test sample, the approval drawing no. R10 3" a dated 2004-08-09 with modification index 'a' dated 2021-01-28 (sheet 1) with certification stamp dated 2021-04-20 must be attached to the EU-type examination certificate and its annex.

2.2 The connection and setting of the rupture valves must be carried out in accordance with the manufacturer's R10 operating instructions with certification stamp dated 2021-04-20.

2.3 Hydraulic fluids recommended by the manufacturer must be used. Hydraulic fluids with a specification outside the scope of the rupture valve are not permitted.

2.4 In the case of rupture valves that are not directly attached to the cylinder, the connection between the cylinder and the rupture valve must be made via by calculation proven short rigid pipes (pressure hoses are not permitted).

2.5 The EU-type examination certificate may only be used in combination with the corresponding annex and enclosure (List of authorized manufacturers of the serial production). The enclosure will be updated immediately after any change by the certification holder.

3 Remarks

3.1 This EU-type examination certificate has been issued in accordance with or on basis of the following standards:

- EN 81-20:2014 (D), Number 5.6.3.8
- EN 81-50:2014 (D), Number 5.9
- EN 81-20:2020 (D), Number 5.6.3.8
- EN 81-50:2020 (D), Number 5.9

A revision of this EU-type examination certificate is inevitable in case of changes or additions of the above-mentioned standards or of changes of state of the art.

3.2 The test results only relate to the safety component "rupture valve" and the associated EU-type examination.

3.3 At the rupture valve, there shall be a label with the information necessary for the component's identification with the name of the manufacturer, EU-type examination sign and details of type.

**Enclosure to the EU-Type Examination Certificate
No. EU-RV 015 of 2021-04-20**



Industrie Service

Authorised Manufacturer of Serial Production – Production Sites (valid from: 2021-02-03):

Company	Blain Hydraulics GmbH
Address	Pfaffenstraße 1 74078 Heilbronn - Germany

- END OF DOCUMENT -

R10 3" Stückliste + Explosionsansicht



20. APR. 2021

GEPRÜFT / APPROVED
TUV SÜD Industrie Service GmbH
Werkzeuglabor für Produkte der Feinmechanik
80669 München
Sachverständigenamt

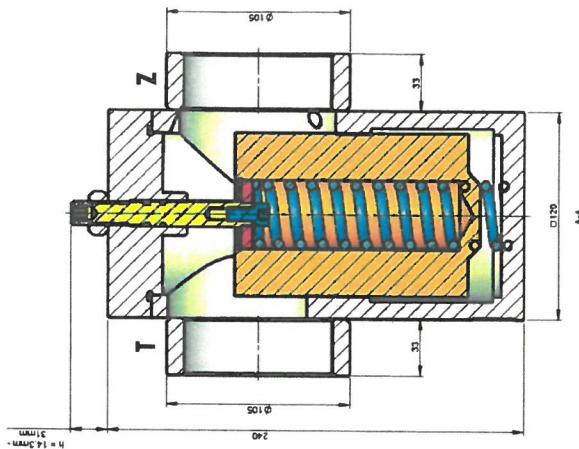
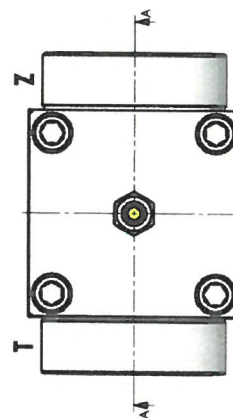
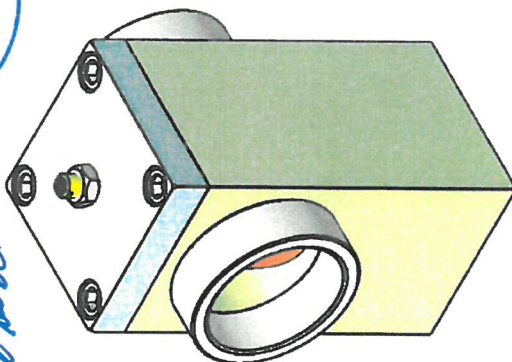
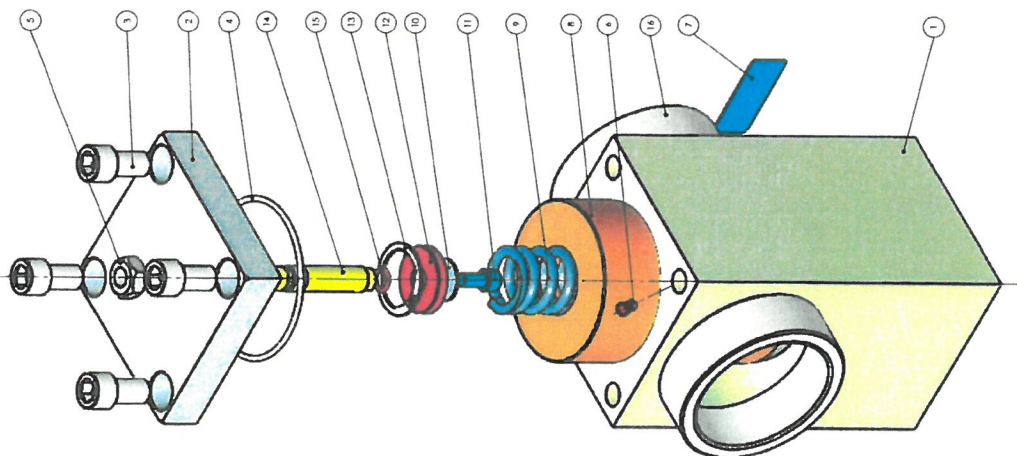

Nr.	Bezeichnung	Zeichnungsnummer	Material	Arbeitsnummer SdL
1	Gehäuse R10 3"	R 114	1.0570 (S355J2C3)	103987
2	Deckel R10 3"	R 124	1.1845 (EN AW-3007)	103731
3	Zylinderbolzen DIN 913 M16x25 schwarzverzinkt	DIN 913 M16x25	schwarzverzinkt	100078
4	O-Ring 60x1 NBR 70	O-Ring 60x1 NBR	NBR	100270
5	Sechskantschraube DIN 913 M16	DIN 913 M16	bleiverzinkt	100123
6	Feder-Düse	R 186 2,8	Aluminium mit Kälber 3M 468	103787
7	Typenschlüssel mit CE 0036	EV 148 CE 0036	1.0718 (115MnPB30)	103718
8	Kolben 3"	R 134	Federstahl EN 10270-1 B4	103737
9	Feder	F 75	1.0718 (115MnPB30)	100162
10	Kolbengehäuse	Kolbengehäuse 6,4 x 2,5 x 1,5 bleiverzinkt	schwarzverzinkt	100065
11	Zylinderbolzen DIN 913 M16	DIN 913 M16	schwarzverzinkt	100100
12	Vormontschraube für R10 3"	R 147	1.0718 (115MnPB30)	103786
13	Schraubstopfen DIN 913 M16	DIN 913 M16	schwarzverzinkt	100033
14	Sechskantschraube R10 3"	R 144 P	1.0718 (115MnPB30)	103781
15	O-Ring 112x NBR 70	O-Ring 112x NBR	NBR	100060
16	Muffe zylinderförmig R10 3"	R 154	1.0570 (S355J2C3)	103812

Zeichnungs-Nr.: **R10 3"**
 Blatt-Nr.: **103995**
 Maßstab: **1:2**
 Datum: **20.04.21**
 Name: **...**
 Position: **...**
 Unterschrift: **...**
 Firmenname: **...**